

# HALE PET DOOR™ UNIVERSAL SCREEN MODEL MIDDLE OF MESH INSTALLATION INSTRUCTIONS



Please read these instructions carefully and completely before attempting to install Hale Pet Doors; they will guide you through the steps and precautions needed for a screen installation. Illustrations and pictures have been added to help you understand various instructions. In order to reach an experienced installer for free consultation, please call 1-800-646-4773. Hale Pet Doors are designed for ease of installation which makes them ideal for any type of screen. Any person with a working knowledge of power or hand tools and basic home construction can install the Hale Pet Door™. It is important to note however, that the product warranty may be affected if returns have been modified in any way other than specified by these instructions. We cannot give credit for a door returned to us damaged.

## A SAFETY REMINDER!

Always wear eye protection and gloves when appropriate.

Before installing: The Hale Pet Door Universal Screen Model is designed to fit into the middle of a screen door frame or screen window frame. In screen frames that are 1/2" thick or less the standard screen model should be used although the universal model will work in those situations as well. The doors are very similar but the installation process differs between the two models. The universal screen pet door is completely reversible and will fit into the middle of the screen frame.

Note: The Hale Pet Door™ screen model is not designed to work on security doors. A “door” model is a much better choice for a security screen application.

**Step 1:** Before installation, be sure that you have the proper size pet door for the pet. If in doubt, larger is better. It may be harmful for the pet to use a pet door that is too small. A good general rule is to install the pet door so that the distance from the floor to the top of the passage opening is above the shoulder of the largest pet. If the customer has more than one pet, make sure the tallest pet has shoulder clearance and the shortest pet will not have to jump through the opening.

**Step 2:** Take a brief look at the large diagrams of the screen model at the end of the instructions and become familiar with various components of the screen model. This will not only help in understanding the terms used in these instructions, but it can be very useful should you need to call for technical support.

**Step 3:** Check the package to make sure that it contains all the necessary parts.



**Complete Kit includes:**

**Installation Booklet (includes warranty, policies, training, etc)**

**Hale Pet Door™ screen model**

**Screen spline 3/16"**

**Phillips head screws 1/4"**

**7/64" drill bit**

**Metal screen retainer clips**

**Screen Stabilizer Bar Kit**

(optional purchase for extra stability)

**Tools and supplies you will need:**

**Drill**

**Razor blade**

**Phillips headed screwdriver**

**Painters tape**

**Needle-nosed pliers (optional)**

**Flat headed screwdriver or putty knife**

**Screen spline roller (handy but not necessary)**

**Step 4:** Determine the placement desired in your screen door for installing the pet door. For the middle of the mesh continue with the following directions.

**Step 5:** Remove the screen window or door from its track. The screen door can generally be removed by lifting it upward and swinging the bottom outward. Occasionally the wheels will interfere with removal. In this case, the wheels will need to be lifted upward to clear the track.



**Step 6:** Lay the screen window or screen door on a flat surface with the screen spline facing upward.



**Step 7:** Looking at the exterior view of the screen door, place the pet screen facing you that you would like to see from the outside. Measure accordingly to make sure the placement is square and level. We recommend no less than 1" from the bottom of the pet screen and the bottom of the screen door. The Universal Screen is designed to be installed anywhere you would like.



**Step 8:** Once you have measured the pet screen out and assured it is level, apply painters tape to keep it from moving. This may take quite a bit on larger screens. The goal is to flip the whole unit over without displacing the pet screen. Once it is flipped over to expose where you would like to apply the spline, re-measure to assure the pet screen is still in the place you desire.

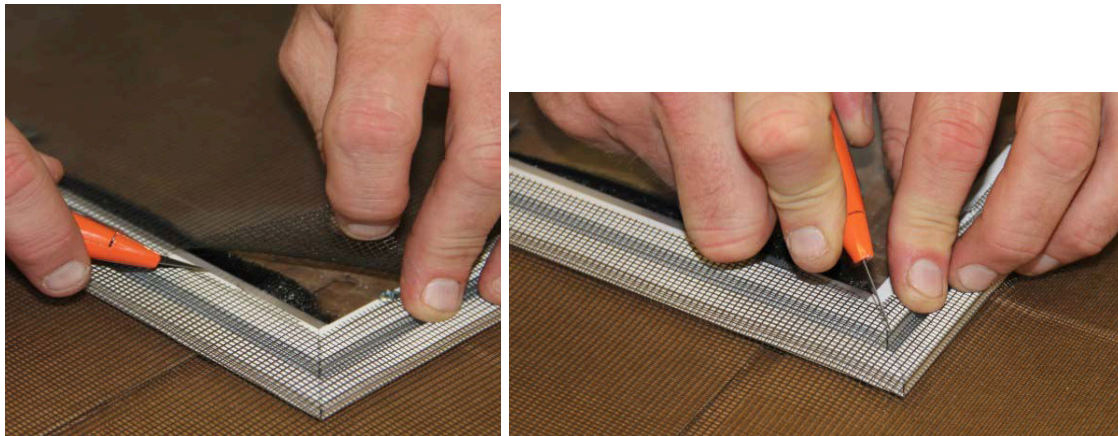

**Step 9:** Cut along the weatherstripping in the pet screen with a razorblade to remove the part of the mesh which will be replaced by the pet screen. Carefully cut at a 45 degree angle along the corner of the pet screen to ease tension of the mesh. (Do not go further than the slot that holds the spline in place)



**Step 10:** Starting in one corner, place the end of the spline provided and carefully work it in the slot to create a “Groove” in the mesh. Push in the spline as much as you can with your fingers. Roll the screen roller tool across the top of the spline until it is fully installed in the slot. Continue until all four sides are in.

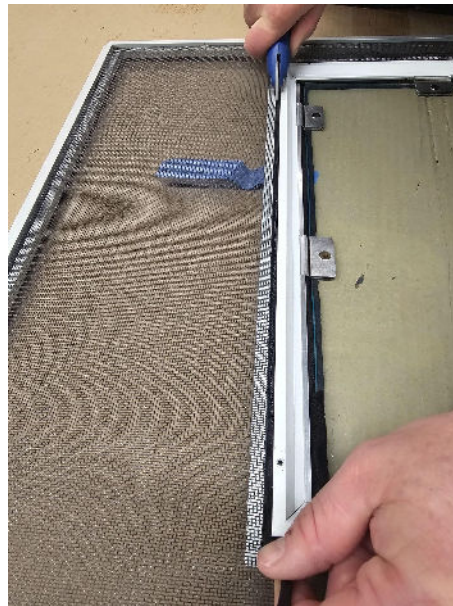

**Step 11:** Using a razorblade, very carefully cut off the remainder of the spline to match the start of the spline. Run a razorblade along the inside of the track to remove any mesh that may be seen.





**Step 12:** Use the retainer clips provided to you in your packet. Make sure to use the right ones. While one side has big clips, the other side will use smaller clips. Align these up in each corner (8 in total). Use the 7/64 inch drill bit also provided to predrill the holes. Use the ¼ inch screws to tighten the retainer clips down to help hold the spline in place.

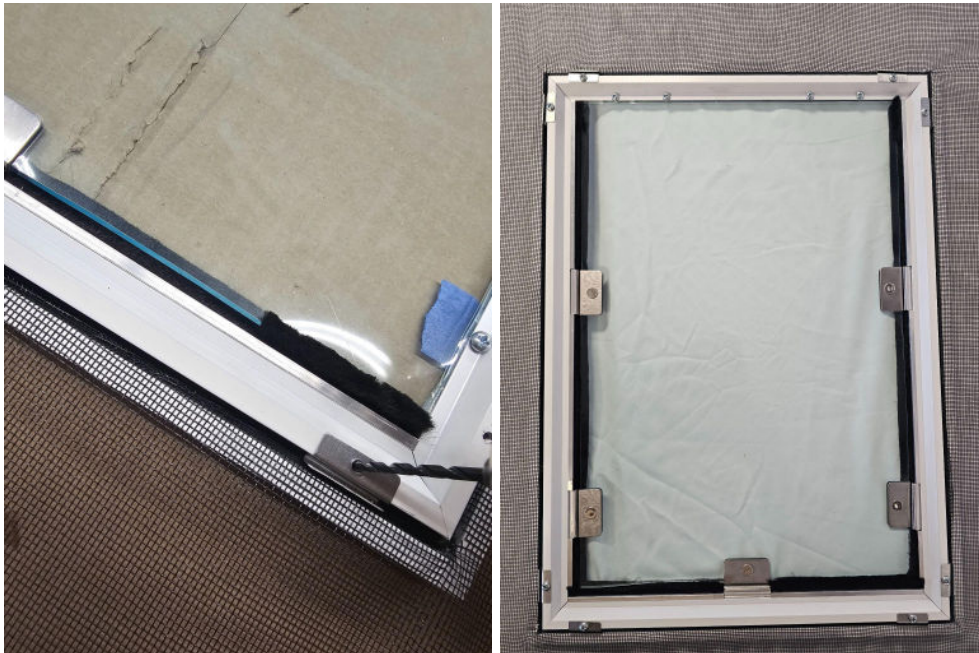

**Step 13:** Remove painters tape and place your screen door back in its track.

**Step 14:** Clean any excess smears off the screen pet door and the flap with a paper towel and simple green, if needed.

**Step 15:** After re-installing the screen into a vertical position, adjust the magnets in the pet door upward or downward if needed. The magnets are pressure fitted and can be adjusted downward by tapping lightly with the handle of your screwdriver. They can be adjusted upward by twisting a flat headed screwdriver below the magnet between the magnet and frame. Be sure to adjust the magnets upward from the inside of the door so as not to mar the outer door finish.

**TECHNICAL SPECIFICATIONS:**

**Flaps:** Single flap made of flexible 3/16" clear PVC vinyl.

**Spline Frame:** Extruded 6063-T5 aluminum with .063" wall thickness.

**Alnico5 Magnets:** A 1/4" rod magnet 1 1/2" long made from an aluminum, nickel and cobalt alloy known for its strength and durability. The door size determines the number of magnets.

**Strikes:** Made of ferrous stainless steel. 1 1/2" long, 3/4" tall and 1/32" thick. U- shaped with interior prongs, when pressed onto the vinyl flap, the barbed prongs hold firmly.

**Weather-stripping:** Flap is surrounded by 1/2" nylon pile for maximum insulation. Nylon is woven into a backing 9/32" wide and 1/32" thick.

